

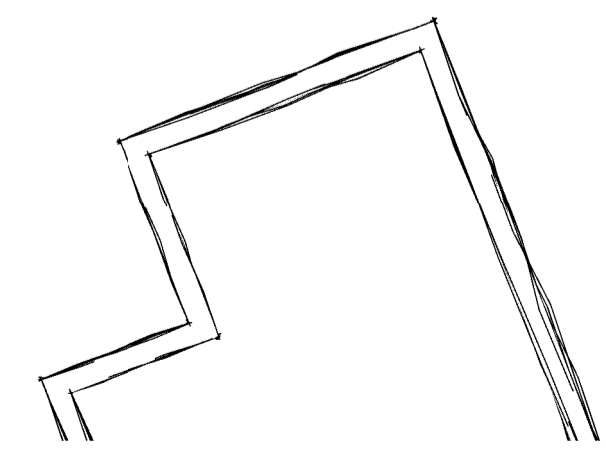

Green denotes route from ground floor entrances to new apartments at 3rd floor.

external balcony access to new floor

third floor plan



13 x 1 Bed Apartments

**hayward**  
ARCHITECTS LTD

19 Station Road  
Hinckley  
Leicestershire  
LE10 1AW  
Tel: 01455 635 665  
Fax: 01455 618 971  
www.hayward-architects.co.uk

Client	<b>Chylesmore Enterprises</b>		
Project Title	Proposed Apartments Quinton Parade Coventry		
Drawing Title	3rd Floor Plan		
Scale	1:100	Sheet	A1
Date	Oct 2020	Author	LJW
Job No.	20/58	Drawing No.	01F
Status	PLANNING		

THE COPYRIGHT OF THIS DRAWING IS VESTED IN HAYWARD ARCHITECTS LTD. REPRODUCTION IN ANY FORM, EITHER IN WHOLE OR IN PART IS FORBIDDEN WITHOUT THE PRIOR WRITTEN PERMISSION OF THE COPYRIGHT HOLDER. DO NOT SCALE FROM DRAWING AND ONLY FIGURED DIMENSIONS ARE TO BE USED.