

Typical Window Detail Elevation 1:10

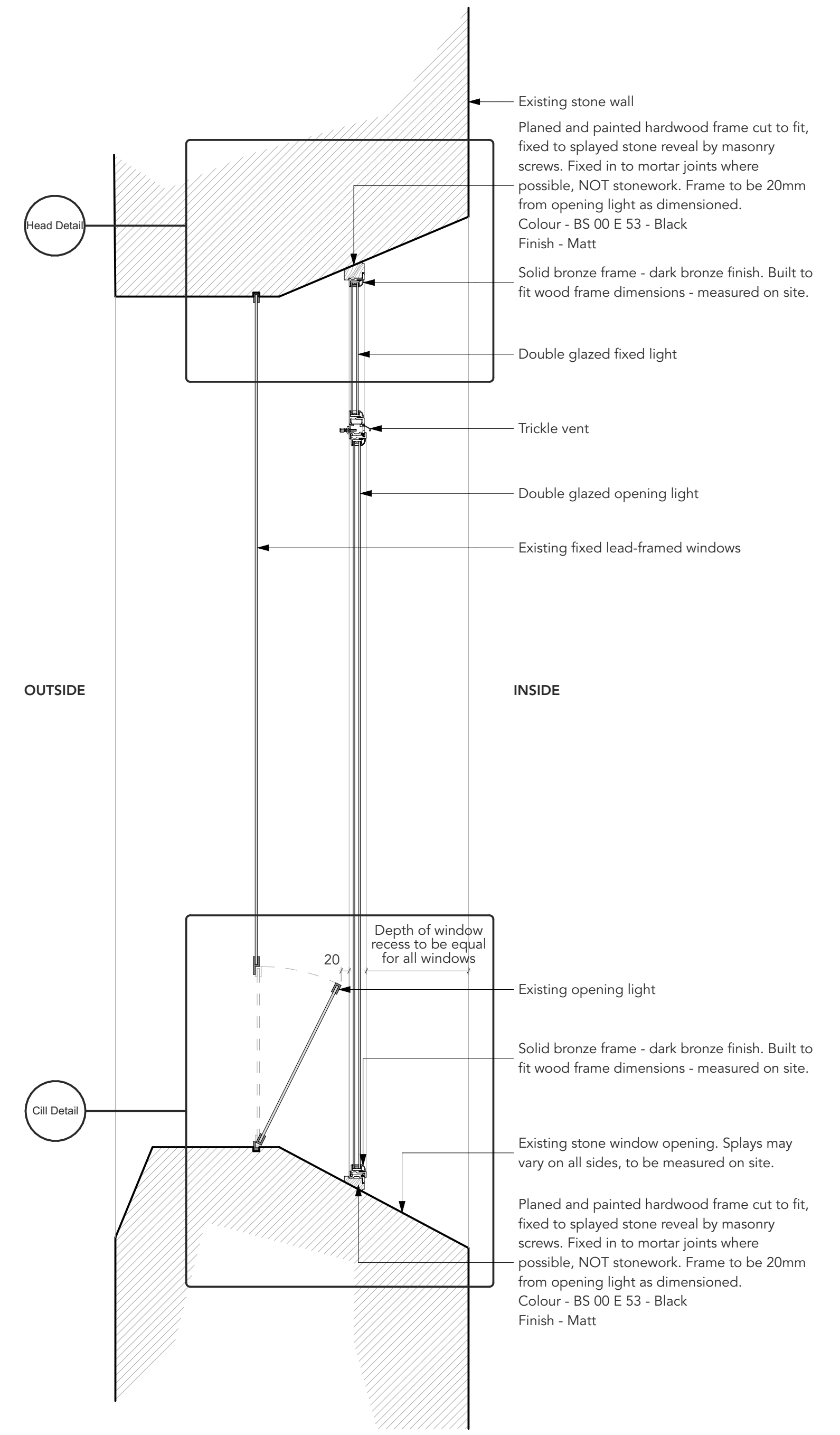

Typical Window Detail Section 1:10

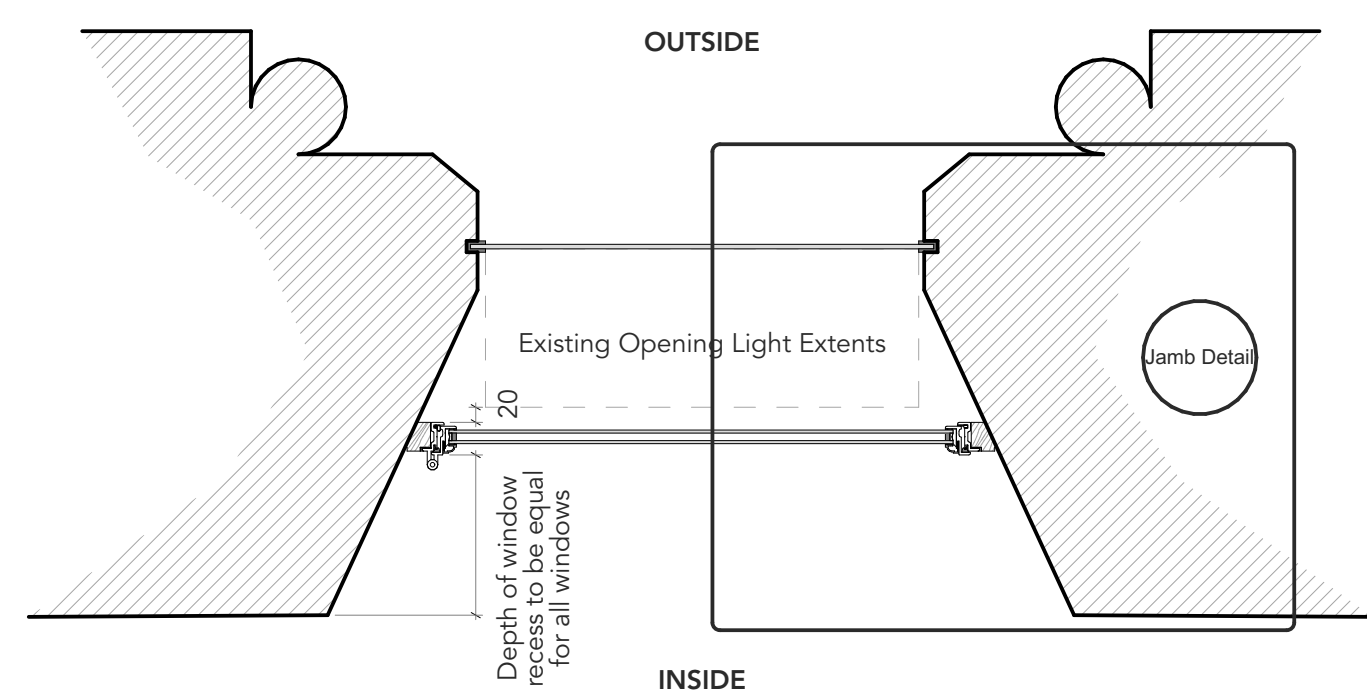
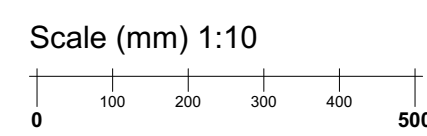

Typical Window Detail Plan 1:10

CAUTION:
HEAVY LIFTING

Notes

Secondary Glazing
Secondary glazing to be solid metal profile double glazed units with min. centre pane U-value 1.1 W/m²•K. Frames to sit within new timber frame to suit splayed stone reveals. Fixings to be into mortar joints where possible and not stone.

Secondary glazing system to be:
Manufacturer: Architectural Bronze Casements or similar approved
<https://www.bronzecasements.com/>
System: Advanced Heritage System
Glazing: 18mm Clear low-iron glass
Colour: Dark Bronze

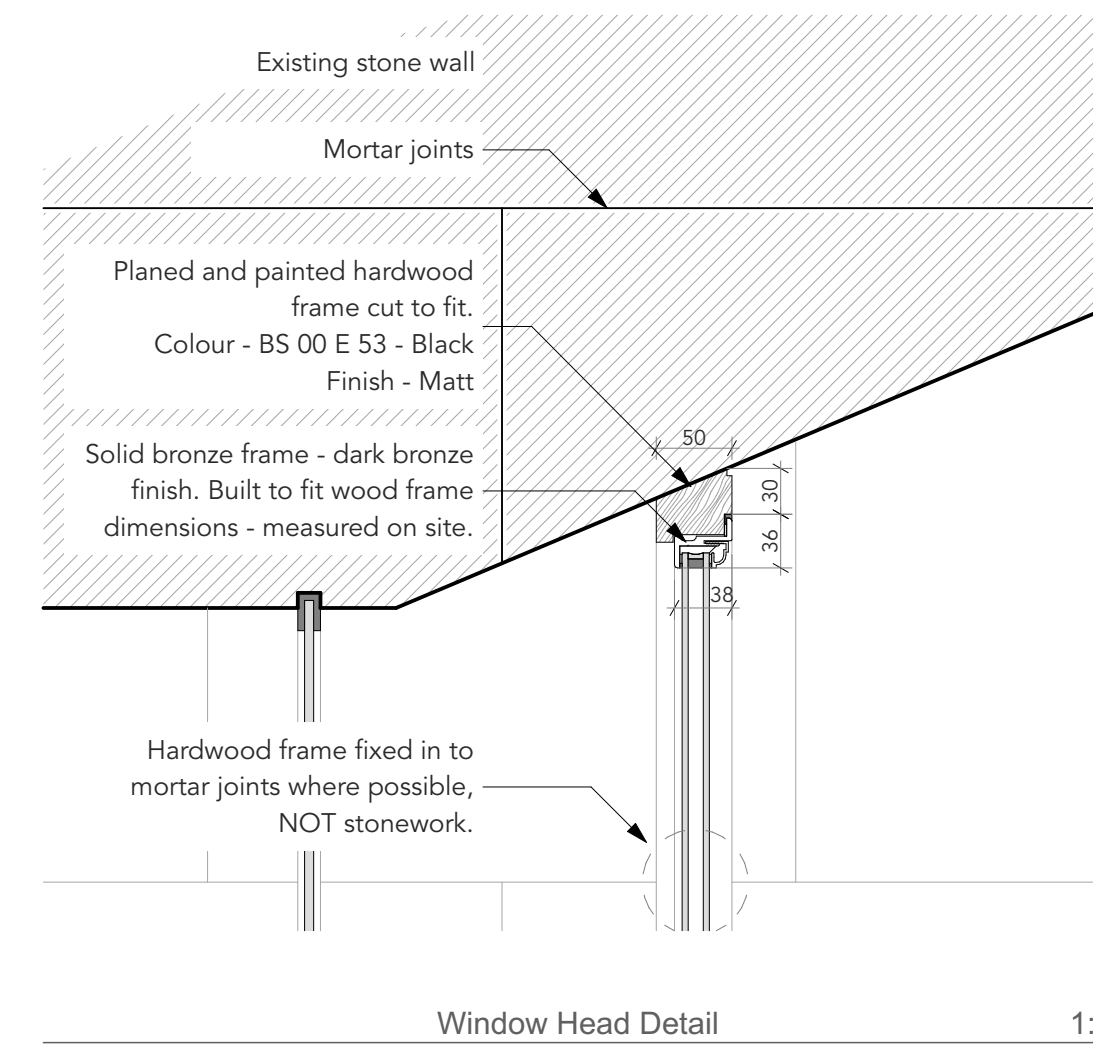

Window Head Detail 1:5

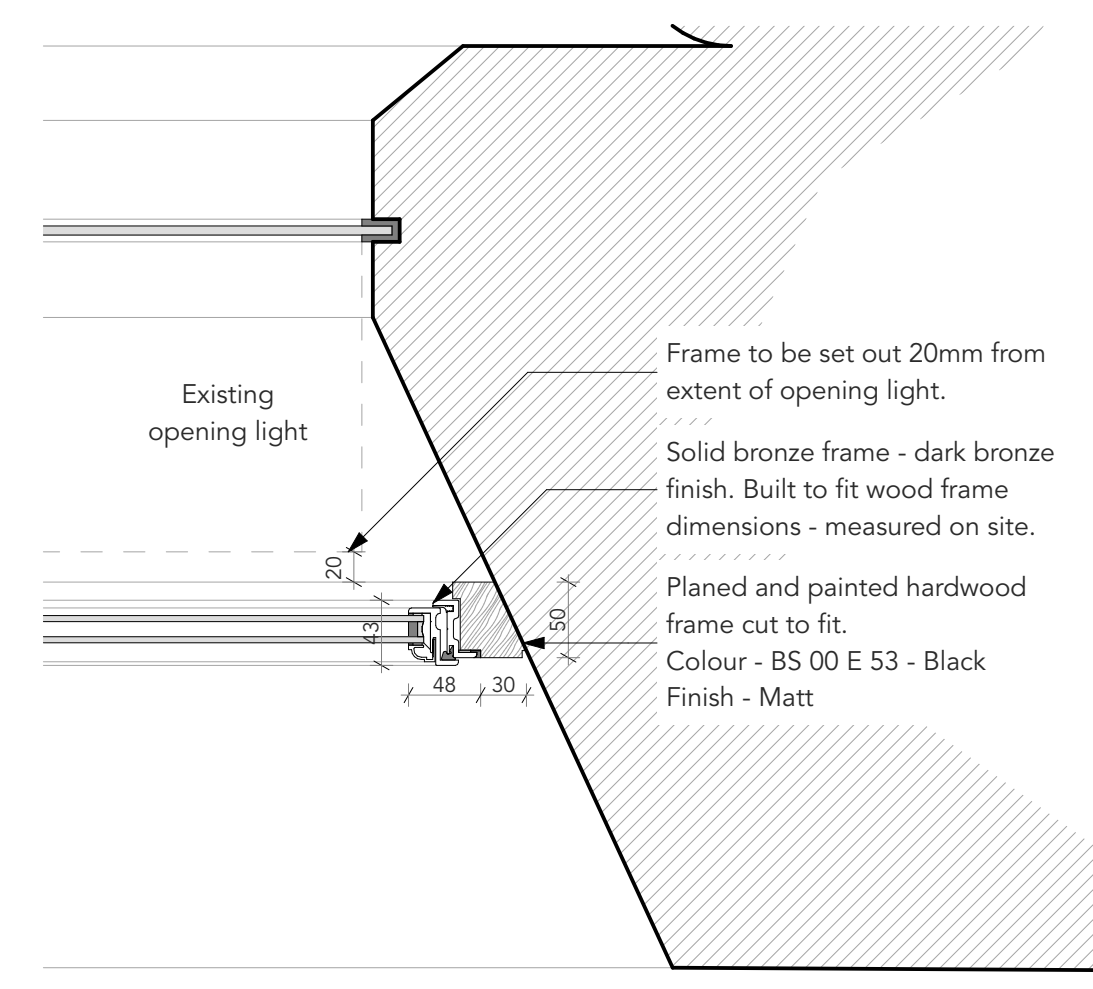

Window Jamb Detail 1:5

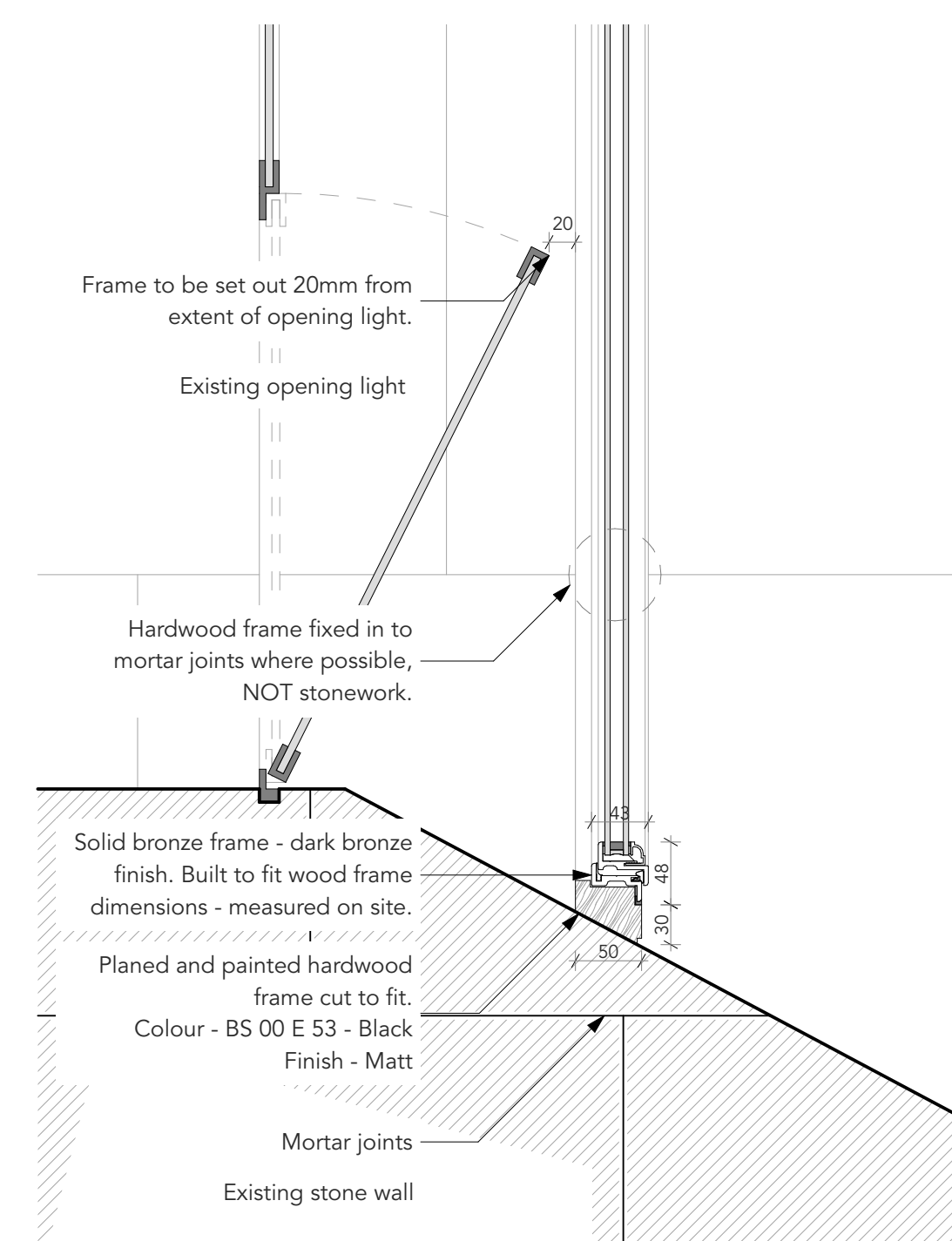

Window Cill Detail 1:5

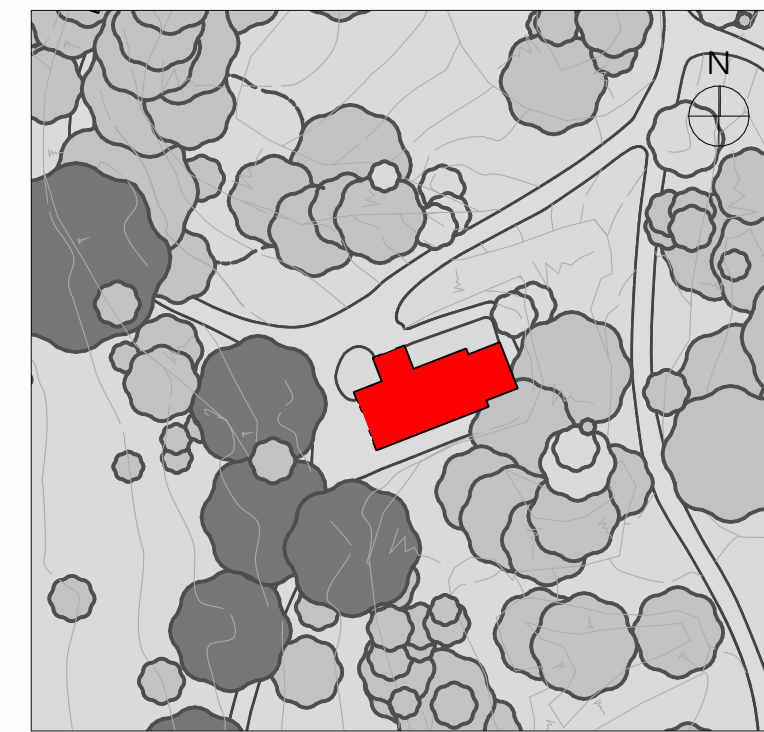
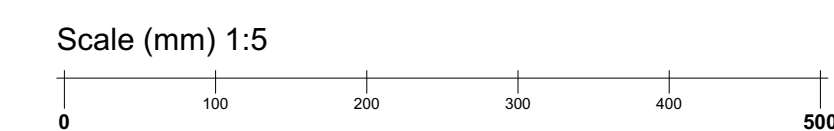

CONSTRUCTION PHASE HAZARD IDENTIFICATION
In accordance with the Construction (Design & Management) Regulations 2015

The hazard sign is a notification to other designers and contractors of foreseeable exceptional risks resulting from the design activities carried out by Maber Associates Ltd. which are beyond those reasonably expected to be identified by a competent person: as defined in the 'Construction (Design and Management) Regulations 2015' - Regulations 9 & 10 and Industry Guidance for Designers (Section 4) published by the CITB (2015)

DRAWING REVIEWED: <i>(yes OR no)</i>	YES
EXCEPTIONAL RISKS/ RISK CONTROL MEASURES: <i>(none OR see warning triangle on drawing)</i>	YES

P02	18/01/21	CDM note added	JDu	Rls					
P01	11/01/21	First Issue	JDu	Rls					
rev	date	description	by	ckd					
PLANNING									
project	London Road Cemetery Anglican Chapel								
document	Additional Works								
document	Typical Secondary Glazing Details								
reference	project	origin	zone	level	type	role	no.	status	rev.
	LRC	MAB	01	XX	DR	A	25201	S2	P02
int. job no.	3343		paper size	A1		scale 1:10, 1:5, 1:50			

architecture / interiors / landscape
maber.co.uk
Leicester

25201

Do not scale from this drawing - dimensions and levels to be checked on site by the contractor. All dimensions in millimetres unless otherwise noted - all levels in metres unless otherwise noted. The title, copyright and confidential information in this document belongs to Maber Associates Limited. Copyright 2020. All rights reserved. You may not reproduce this document or disclose it to others without the consent of Maber Associates Limited.