

Notes

THIS SURVEY HAS BEEN PREPARED WITH A SCALING ACCURACY FOR A PLOT AT A SCALE OF 1/200

ALL LEVELS ARE IN METRES AND RELATED TO A TBM LOCATED ON MAN HOLE COVER AS SHOWN (value 100.00m).

THE CO-ORDINATE GRID IS BASED ON ASSUMED VALUES

ALL TREE HEIGHTS AND SPREADS ARE APPROXIMATE

WE HAVE TRIED TO IDENTIFY TREE TYPES, HOWEVER IF TREE SPECIES ARE CRITICAL SPECIALIST ADVICE SHOULD BE GAINED.

DRAINAGE PIPE SIZES HAVE BEEN MEASURED FROM THE SURFACE, CHAMBER ACCESS HAS NOT BEEN GAINED FOR SAFETY REASONS, THEREFORE SIZES SHOULD BE REGARDED AS APPROXIMATE

STA	EASTINGS	NORTHINGS	LEVEL
ST01	10000.000	5000.000	100.088
ST02	10006.889	5020.008	100.874
ST03	10002.240	5044.507	100.639
ST04	9990.825	5036.907	100.279
ST05	9959.872	5024.655	98.740

bl bed level
 cl cover level
 il invert level
 tl threshold level
 utl unable to lift
 wl water level

5050N

5000N

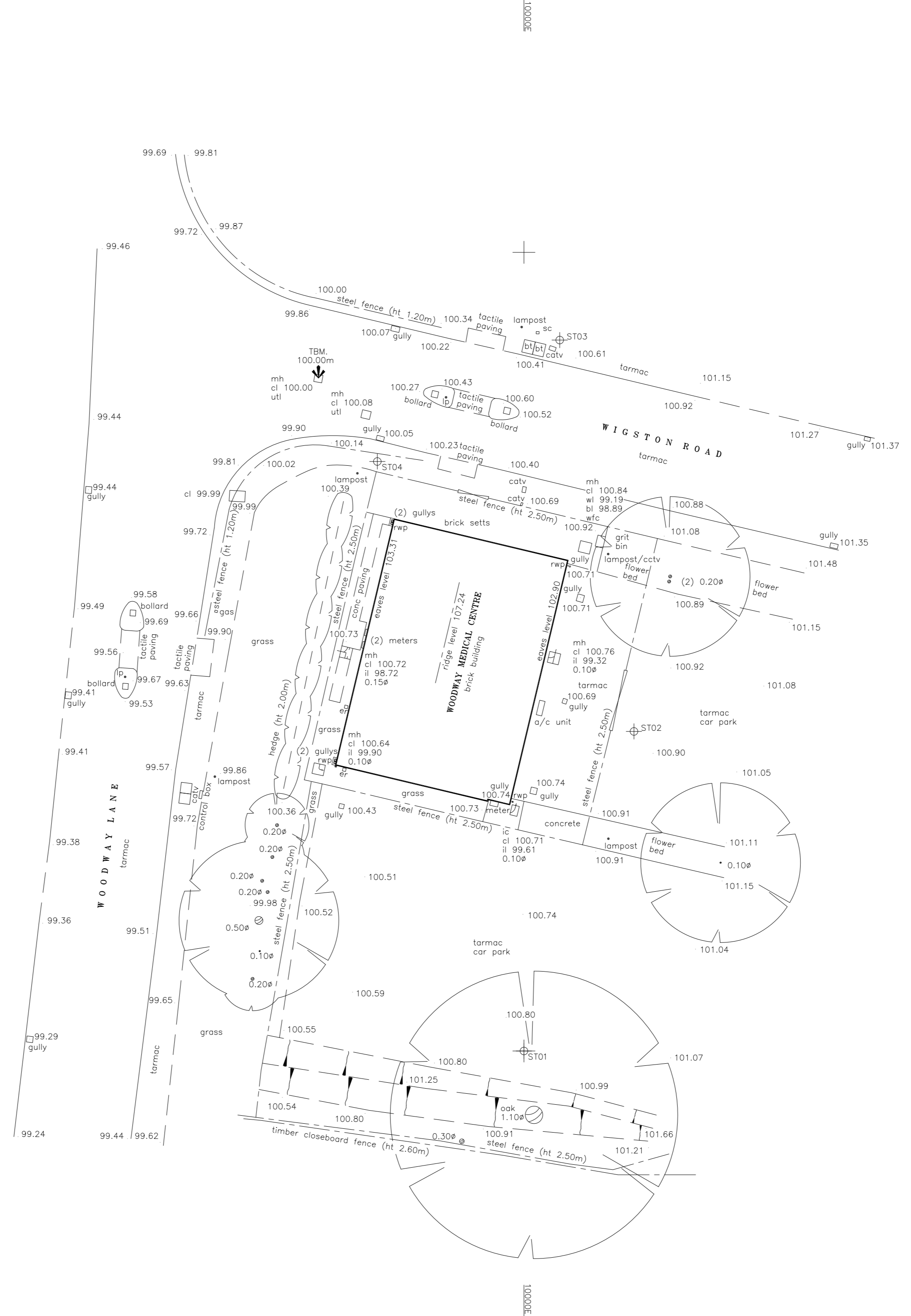
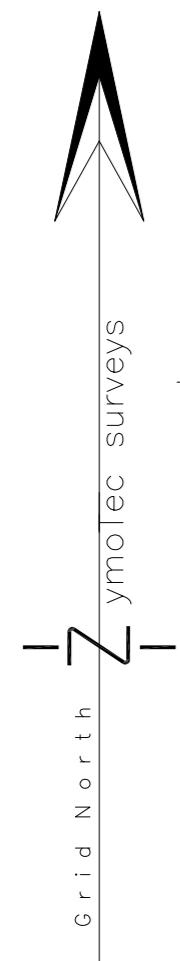

SJF/SAH © ZymoTEC Surveys Ltd. A/CAD

job
WOODWAY PARK MEDICAL CENTRE
WIGSTON ROAD
COVENTRY
CV2 2RH

client
ALAN C RILEY ASSOCIATES

title LAND SURVEY	dwg no. 1293/1
----------------------	-------------------

scale 1/200 @ A2	date FEBRUARY 2008
---------------------	-----------------------

ZymoTEC Surveys

THE STANDARD FOR ACCURACY

TOPOGRAPHICAL AND MEASURED BUILDING SURVEYORS
 PO Box 4256, Leamington Spa, CV31 9BZ
 TEL: 01926 429565 FAX: 01926 429565
 E-MAIL: info@zymotecsveys.com
 www.zymotecsveys.com