

The copyright of this drawing is vested with Corstorphine + Wright Ltd and must not be copied or reproduced without the consent of the company.

Figured dimensions only to be taken from this drawing. DO NOT SCALE.

All contractors must visit the site and be responsible for checking all setting out dimensions and notifying the architect of any discrepancies prior to any manufacture or construction work.

**NOTES:**  
 This drawing should be read in conjunction with all subcontractor & consultant information issued for this project. At the time of issue this includes; Tandem Projects, Bakerflicks, TheEngineeringPractice, Lazzari Creative Interiors, PMP Consultants & Greylfrans Catering Equipment.

The information provided indicates design intent of the windows, and the contractor is responsible to provide fabrication dwgs.

Frame dimensions are approximate.

- \* All existing dimensions and conditions to be verified by contractor on site.
- Shaded items are existing to remain. All exterior and interior finishes are to be protected in place to prevent damage.
- Indicative manifestation to comply with Approved Document part K. Manifestation design TBC.
- Float Glass Design - Reeded Glass - refer to interior designer drawing for details.

Note: Mullion/transom/frame profile are shown indicatively only. Size of the face cap and backbox to be confirmed by glazed screens manufacturer.

- External Curtain Walling Ground Floor **NBS: H11/110**
- External Curtain Walling First Floor **NBS: H11/115**
- External bi-folding doors as **NBS: L20/520A**
- External Windows as **NBS: L10/330**
- External Doors as **NBS: L20/490**
- Internal folding doors single glazed as **NBS: L20/520B**
- Internal folding doors **NBS: L20/520C**
- Internal glazed screen as **NBS: L20/520D**
- Internal glazed door as **NBS: L20/520D**

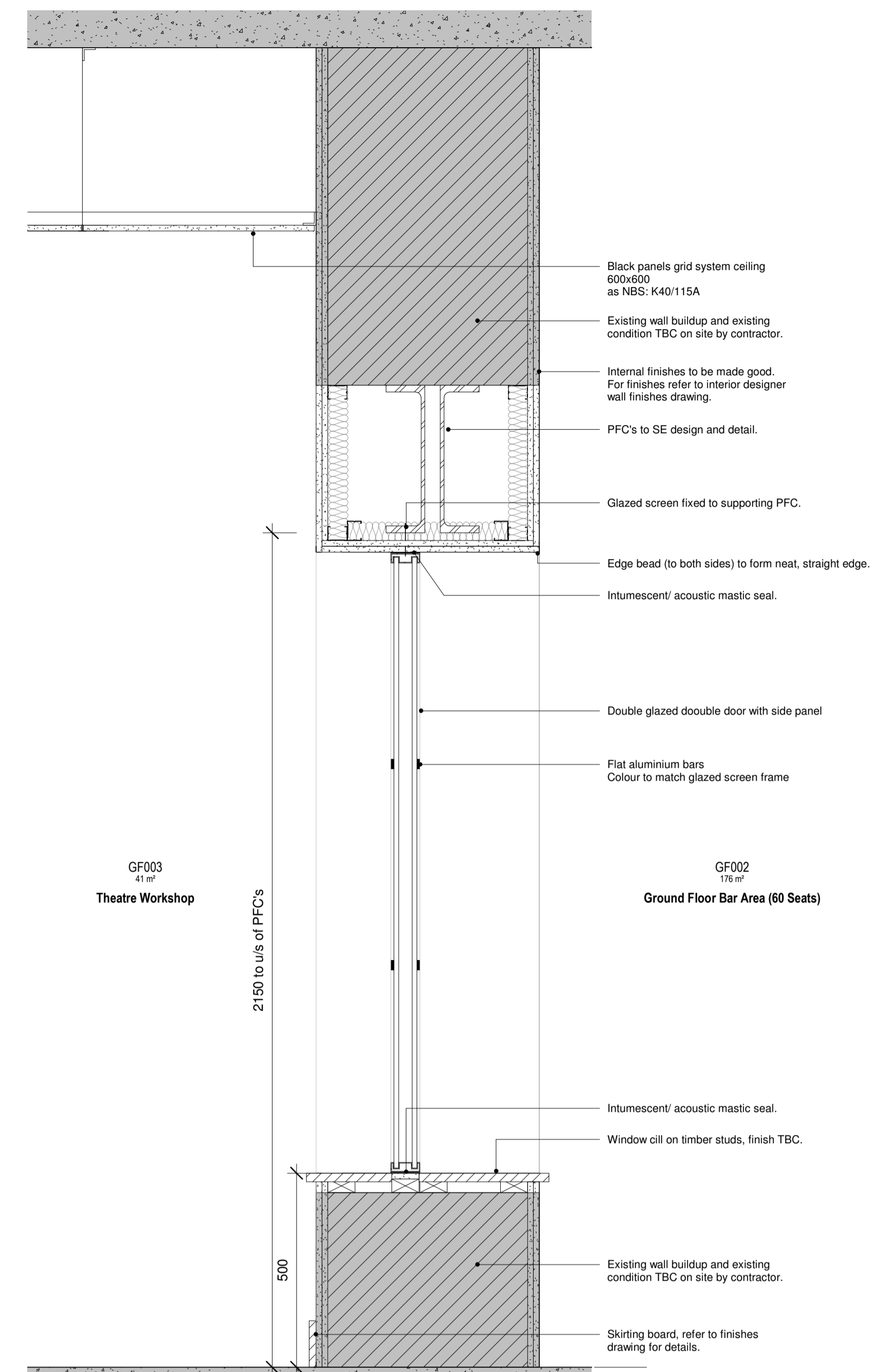

**B** 4002 - Section B  
1 : 10

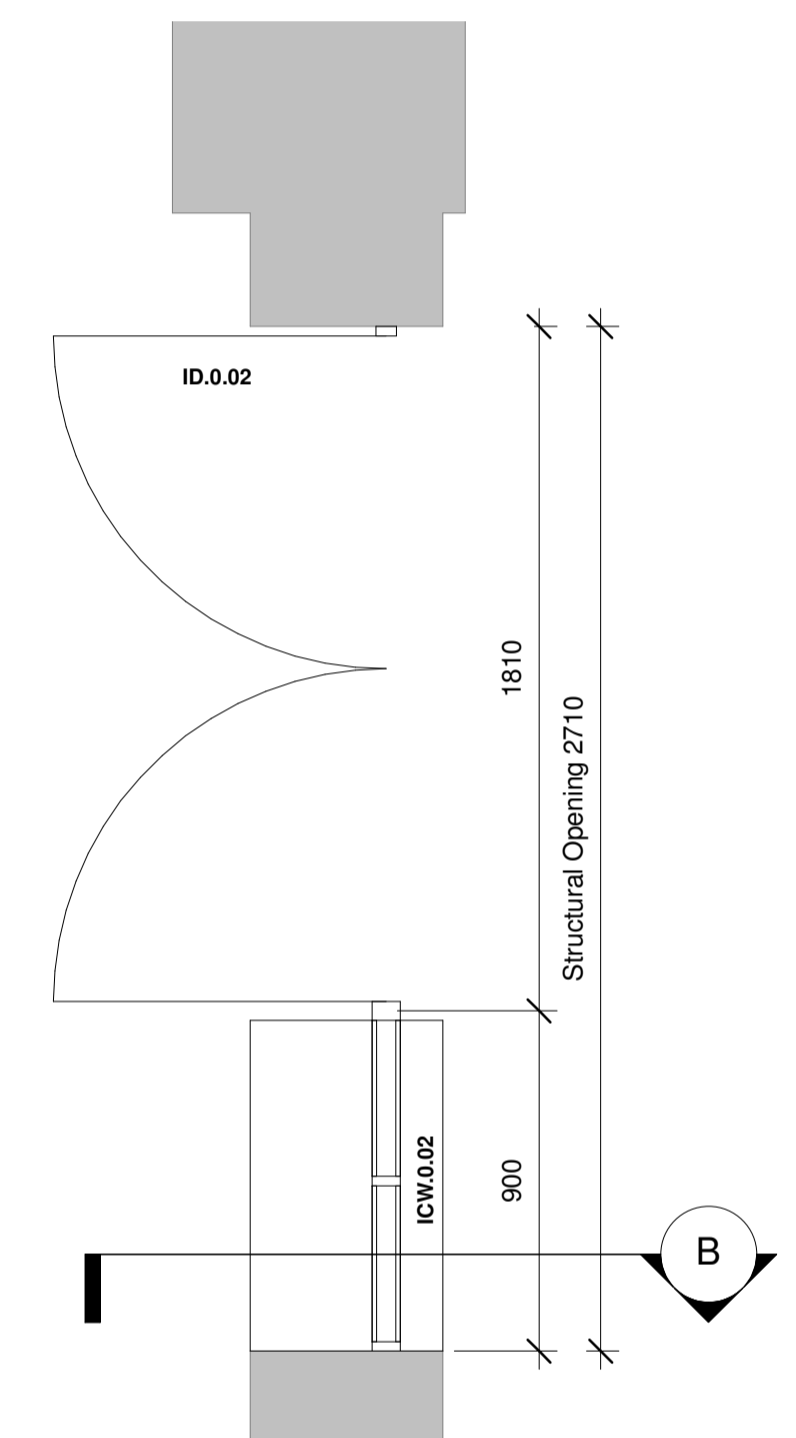

**A** 4002 - Elevation A  
1 : 20

**1** 4002 - Internal Glazed Screen ICW.0.02  
1 : 20

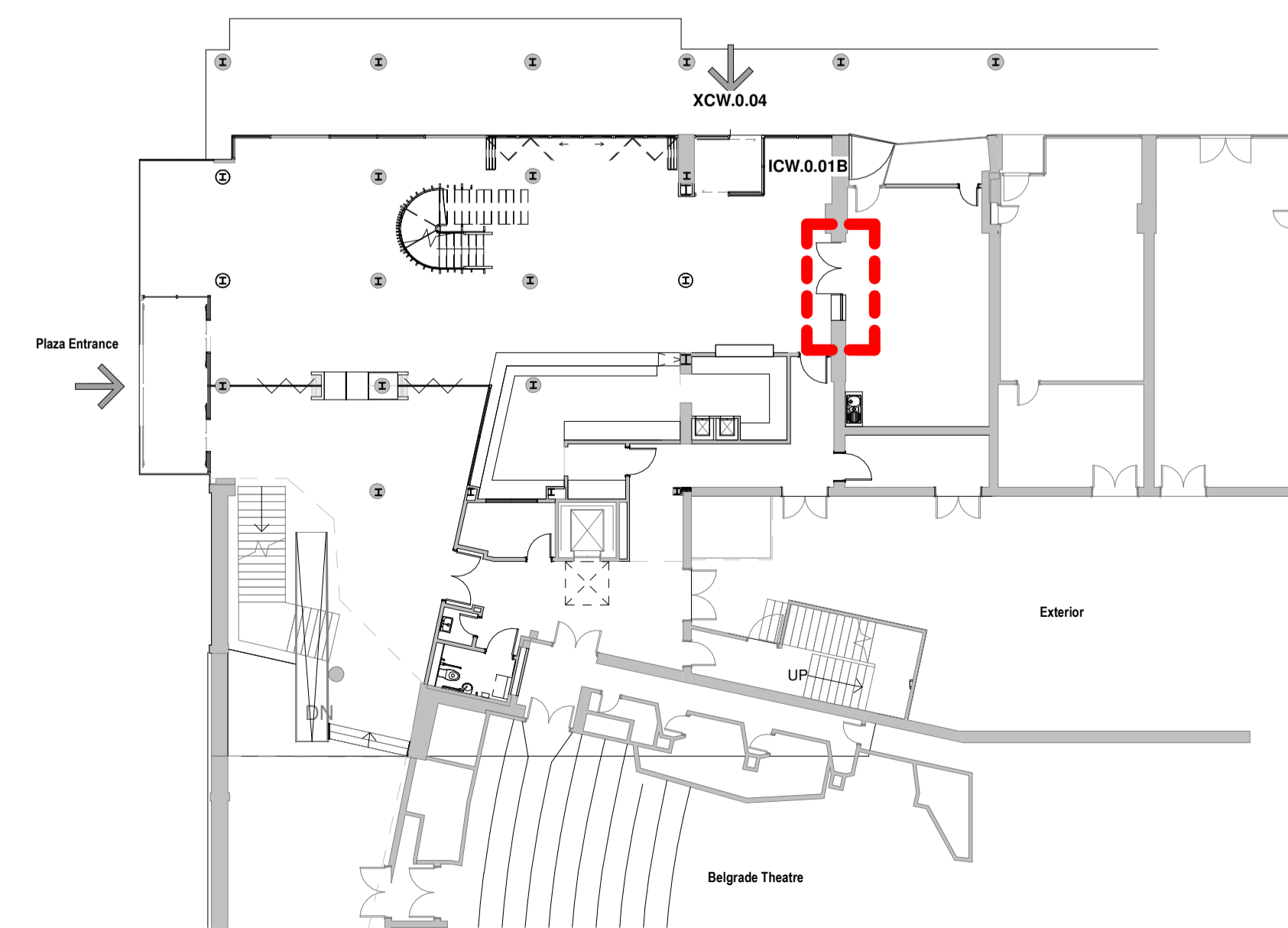

Rev	Description	Date	Dr	App by
D	Contract Issue	02/03/20	MW	RK
C	Internal blinds omitted	22/01/20	MW	RK
B	Issue for Tender - Spec revised	29/11/19	MW	RK
A	Issue for Tender	15/11/19	MW	RK
-	Stage 4 Draft Issue	01/11/19	MJ	RK

Project Stage

# CONTRACT

Client:  
Belgrade Theatre Coventry

Project:  
Belgrade Theatre - Phase II

Drawing Title:  
PHASE 2 - Internal Glazed Screen - Ground Floor  
3/3

Drawn	Checked	Paper Size	Scale	Date
MW	RK	A1	As indicated	NOV 2019

Drawing No.  
18477-CW-XX-00-DR-A-4002

Drawing BIM Name:  
18477-CW-P2-ZZ-M3-A-BUILD-S0\_BelgradeTheatreCafe

CDE Area:	Suitability Code:	BIM Revision:
S0		P01.01

**CORSTORPHINE + WRIGHT ARCHITECTS**

Warwick  
London  
Birmingham  
Manchester  
Leeds  
Canterbury  
Glasgow  
Dublin

Alpha Works at Alpha Tower • Suffolk Street Queensway  
Birmingham • B1 1TT  
Tel. 01217378350 www.corstorphine-wright.com