

FOR CONTINUATION SEE: FAH-BDP-XX-XX-DR-L-90-P011

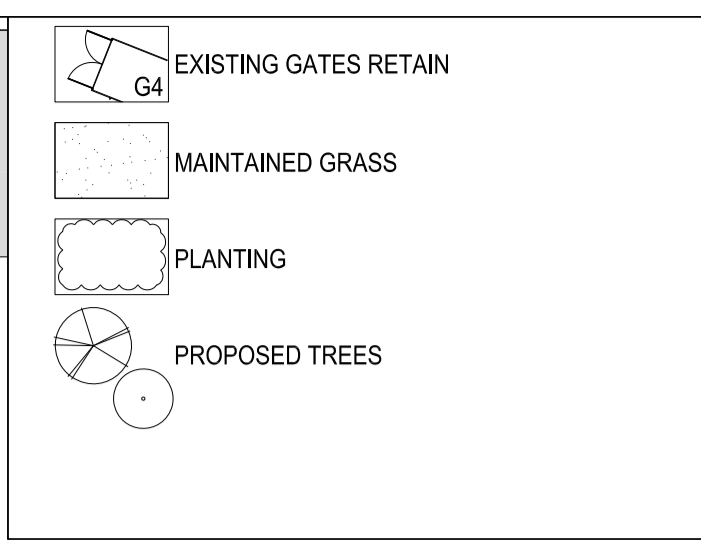
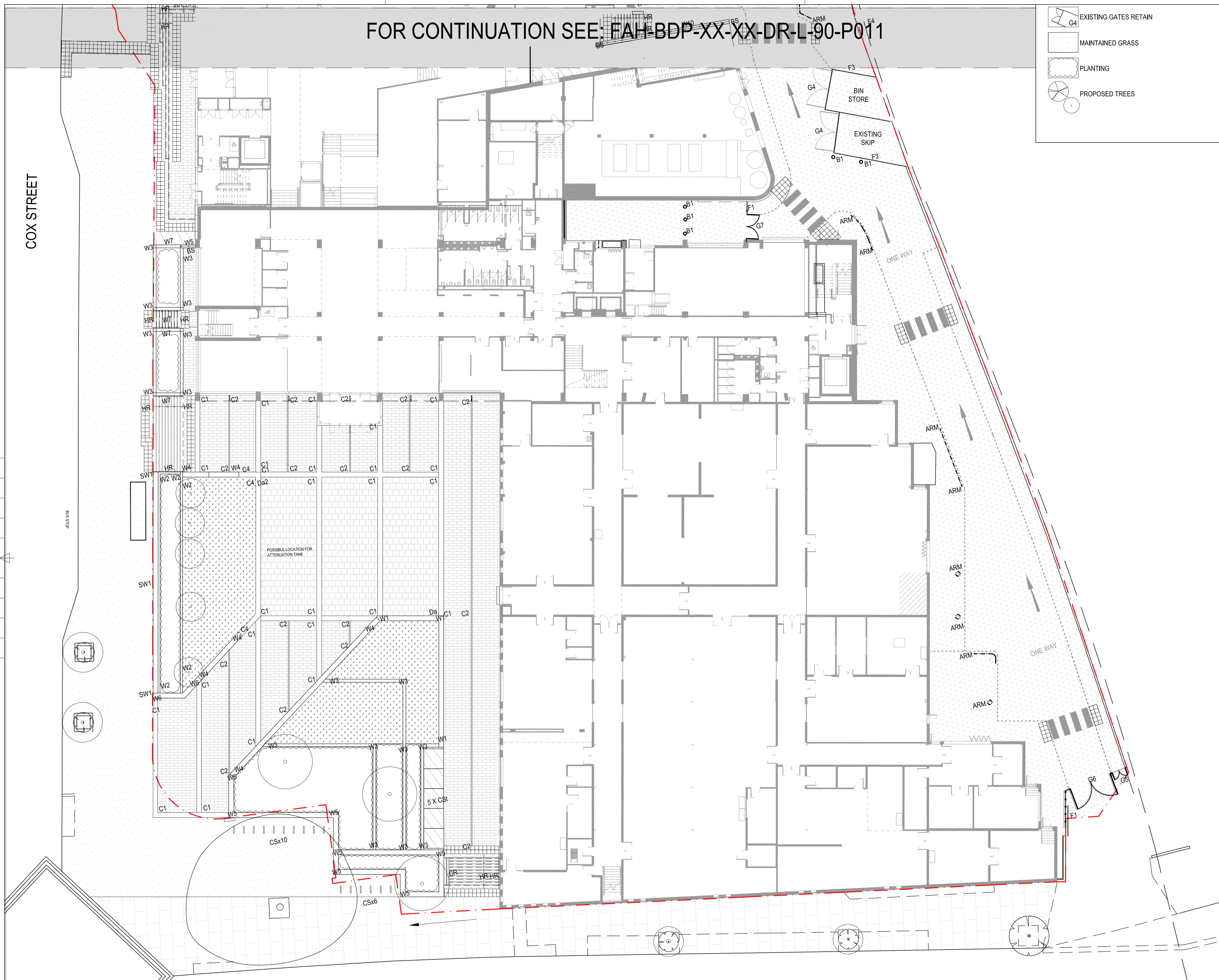

- KEY**
- PAVING MIX A
 - PAVING MIX B
 - EXISTING PAVING MADE GOOD WHERE NECESSARY
 - EXISTING TARMAC MADE GOOD WHERE NECESSARY
 - EXISTING SERVICE YARD TARMAC MADE GOOD WHERE NECESSARY
 - PROPOSED PEDESTRIAN GARDE TARMAC
 - PROPOSED VEHICLE GARDE TARMAC
 - CONCRETE PAD FOUNDATION REFER TO ENGINEER DRAWINGS
 - "C1" PAVING CHANNEL TYPE 1
 - "C2" PAVING CHANNEL TYPE 2
 - "K1" RAISED KERBS
 - "TK" TRANSITION KERB
 - "C3" PAVING CHANNEL TYPE 3
 - "K3" FLUSH KERB
 - "W1-W7" PRECAST CONCRETE RETAINING WALLS
 - "W2" WEATHERED STEEL WALL
 - "W4" CONCRETE RAKED WALLS
 - "W8-W10" INSITU CONCRETE RETAINING WALLS
 - "SW1" TIMBER TOP SEAT WALL
 - TACTILE PAVING
 - HAZARD WARNING PAVING
 - STEPS
 - CYCLE RAMP
 - HANDRAILS
 - BALUSTRADES
 - CYCLE STANDS
 - "CS1" CYCLE STORE
 - CYCLE POD
 - Da1 POWER / DATA OUTLET FOR BIG SCREEN EVENTS
 - Da2 POWER / DATA / WATER OUTLET FOR POP UP RETAIL
 - B1 STATIC BOLLARD
 - B2 DROP BOLLARD
 - WHITE LINING (REFER TO ENGINEERS DRAWINGS)
 - DRAFT POSITION OF ARMCO BARRIERS (REFER TO ENGINEERS DRAWINGS)
 - F1 BLADE RAILINGS - VERTICAL METAL BAR
 - F3 EXISTING FENCE RETAIN
 - F4 FENCE INFILL TO MATCH EXISTING
 - Gx GATES TO MATCH ADJACENT FENCE TYPE

NOTES

TO BE READ IN CONJUNCTION WITH DRAWINGS:

FAH-BDP-XX-XX-DR-L-90-P002 LANDSCAPE MASTERPLAN
 FAH-BDP-XX-XX-DR-L-90-P003 LEVELS PLAN
 FAH-BDP-XX-XX-DR-L-90-P004 SECTIONS
 FAH-BDP-XX-XX-DR-L-90-P010 LANDSCAPE GA 1 OF 2
 FAH-BDP-XX-XX-DR-L-90-P011 LANDSCAPE GA 2 OF 2
 FAH-BDP-XX-XX-DR-L-90-P201 PLANTING STRATEGY
 FAH-BDP-XX-XX-DR-L-90-P202 TREE FT DETAILS
 FAH-BDP-XX-XX-DR-L-90-P203 TYPICAL CONSTRUCTION DETAILS

LANDSCAPE OUTLINE SPECIFICATION
 FAH-BDP-01-XX-SP-01-001 - OUTLINE SPECIFICATION

REVISION DESCRIPTION	DRAWN	CHECKED	DATE	REVISION DESCRIPTION	DRAWN	CHECKED	DATE	REVISION DESCRIPTION	DRAWN	CHECKED	DATE
D STAGE 3 VE AMENDMENTS	CZ	EW	03/05/19	C STAGE 3 ISSUE	EW	JRM	12/02/19	B DRAFT - ESCAPE STAIR RE-ALIGNED, ATTENUATION TANK PROVISIONALLY LOCATED	EW	EW	30/01/19
E UPDATED IN LINE WITH REVIT MODEL	CZ	EW	09/05/19	A DRAFT - ISSUED FOR COSTING	EW	EW	10/01/19	FIRST ISSUE	EW	EW	08/01/19

BDP.

2 Bruce Street
Belfast BT2 7JD
United Kingdom
T +44 (0)28 9024 3394
F +44 (0)28 9032 9337
www.bdp.com

COVENTRY UNIVERSITY - FACULTY OF ARTS AND HUMANITIES.

P2007391

LANDSCAPE GA

SCALE @ A1
1:200

DATE
JAN 19'

REVISION
E