

Lower Ground Floor Plan

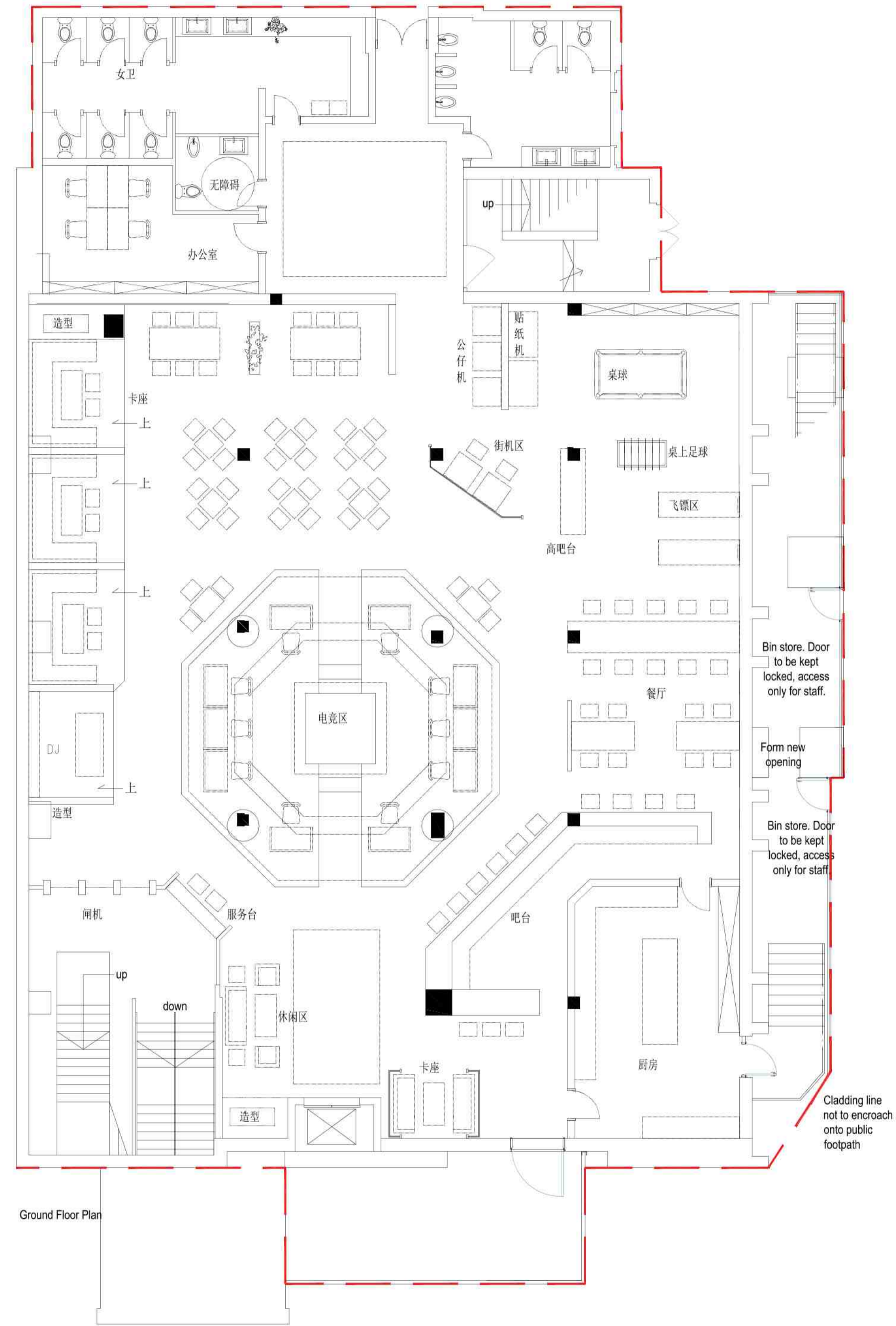

Ground Floor Plan

Legend :

- ATEF** Approved type of emergency fastenings
- E** Fire Exit sign
- E** Exit directional sign
- E** Exit directional boxes
- ED** Emergency lighting points
- 1** Fire extinguisher : water type
Red label
- 2** Fire extinguisher : carbon dioxide type
Black label
- 3** Fire extinguisher : foam type
Cream label
- 4** Fire extinguisher : wet chemical type
Yellow label
- R** Refuge
- Fire alarm call points
- DS** Automatic smoke detection
- DH** Automatic heat detection
- Bx** Fire blanket(s)
- ip** Fire alarm indicator panel
- Audible and visual warning devices
- CC** CCTV

Based on survey by others.
Drawing for planning purposes only.
Drawings Copyright © Michael Ramus Architects and not to be passed to any other party without written consent.
All dimensions to be checked on site.
All specialist manufactures (i.e. door, windows, cladding etc) to check all dimensions on site prior to manufacture.
All queries must be brought to the attention of the client/architect prior to manufacture.

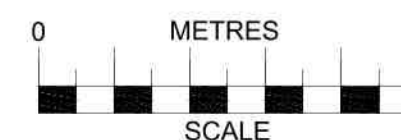

Rev.G. 31-5-19 - cladding line amended
Rev.F. 29-3-19 - internals amended

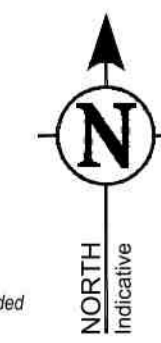

Change of Use from current
Sui Generis Nightclub to
Sui Generis 'E-Sports Bar
Entertainment Centre with
Karaoke Private Rooms

Players KTV Ltd

1519-01_G

Proposed Basement and
Ground floor plans

1:100 @ A1

Planning Change of use

9th March 2018

Michael Ramus Architects
76 Priory Road, Kenilworth,
Warwickshire, CV8 1LQ
01926 512 400
info@ramus-architects.co.uk