

FILENAME: \\LDS-DC-04-101\DATA\PROJECTS\A087905-34-13\QINETIQ.OLD\MANOR HOUSE\B.0 DRAWINGS\OPTION 2 - OFFICE (MINIMAL STRUCTURAL ALTERATION)\OPTION 2 - MANOR HOUSE TEMPLATE - FLOOR PLANS.DWG | PLOTTED BY: RYAN KIRK | PLOTTED DATE: 08 April 2019 15:25:37

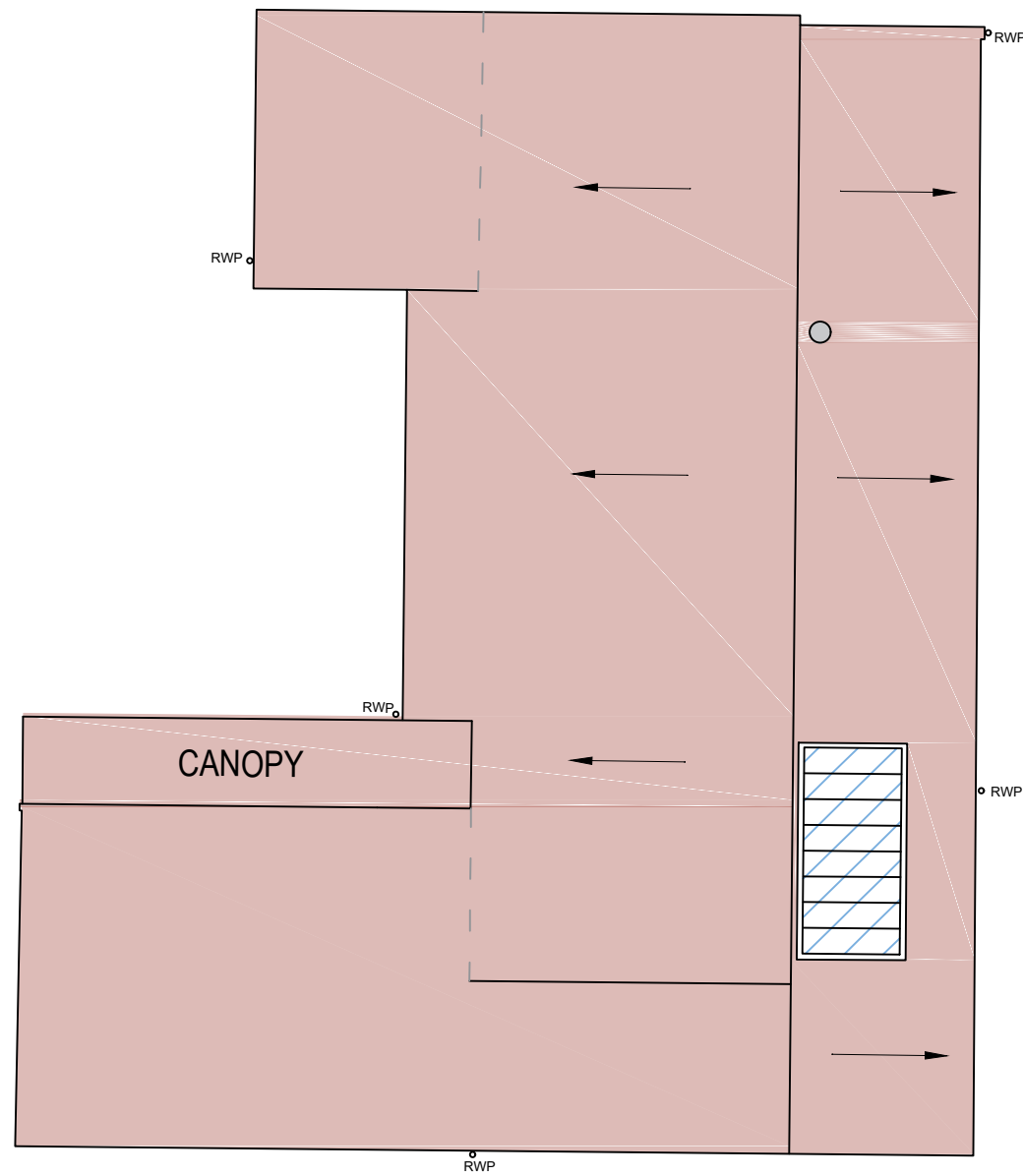

**EXISTING - ROOF PLAN**

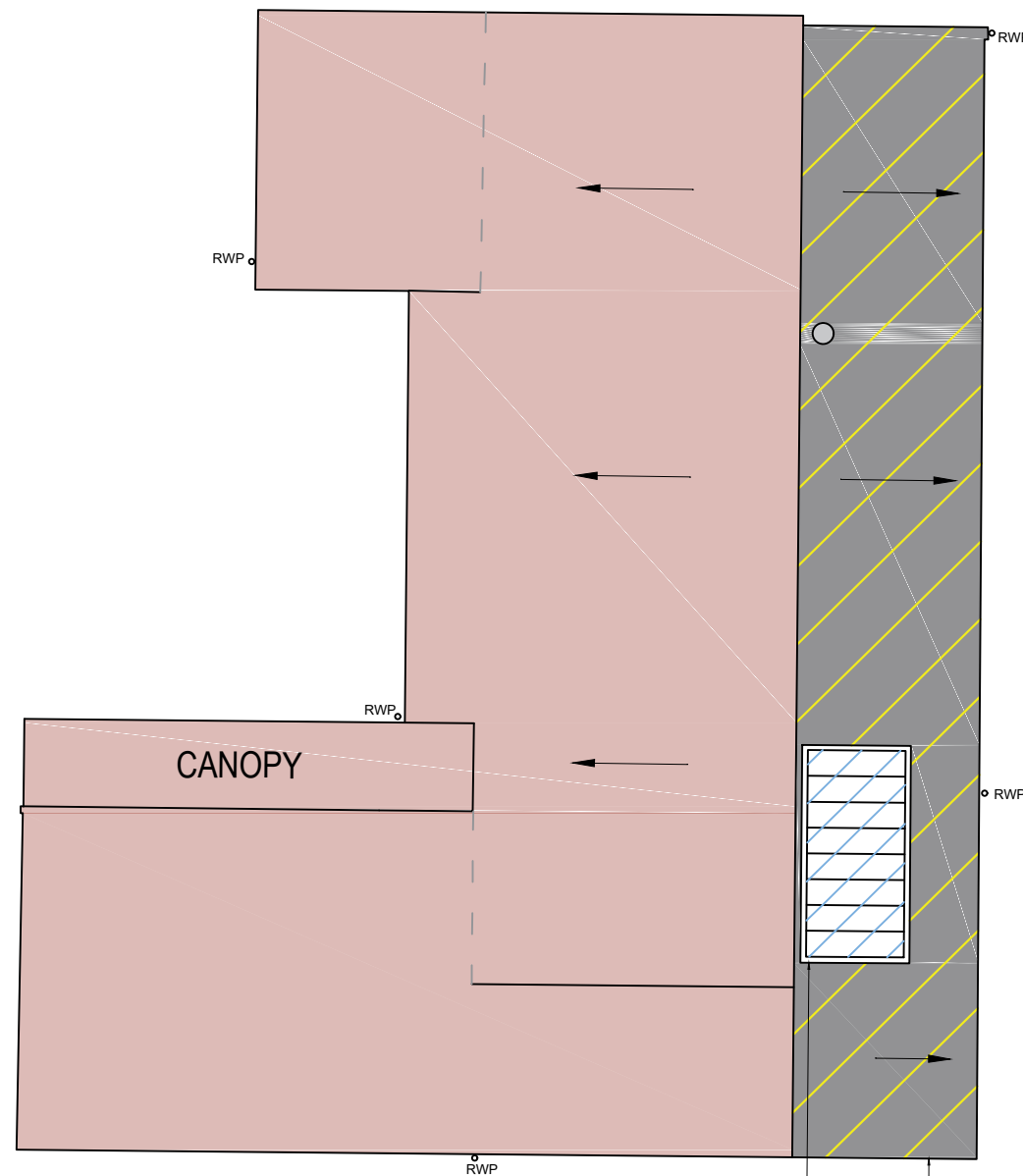

**PROPOSED - ROOF PLAN**

HATCHED AREA  
DEPICTING EXTENT OF  
ROOF UPGRADE  
WORKS. ROOF RAISED  
130MM - 140MM NEW  
BUILT UP REINFORCED  
BITUMEN MEMBRANE  
WARM DECK ROOF  
COVERING (COLOUR:  
CHARCOAL)

NEW ALUMINIUM  
REINFORCED RIGID  
PVCu ROOFLIGHT.  
COLOUR: WHITE.



**FOR INFORMATION ONLY**

REV	DESCRIPTION	BY	CHK	APP	DATE
01	EXISTING & PROPOSED - ROOF PLAN	RK	JT	JT	01/05/19

SHIRLEY ROAD HEALTH CENTRE  
189 SHIRLEY ROAD, ACOCKS GREEN  
BIRMINGHAM  
B27 7NP



ARNDALE COURT  
HEADINGLEY  
LEEDS  
LS6 2UJ



TEL: +44 (0)113 278 7111  
FAX: +44 (0)113 278 3487  
e-mail: leeds@wyg.com

Project: A087905-34-13

STOKE ALDERMOOR CLINIC - MALLING HEALTH  
ALDERMOOR LN, COVENTRY, CV3 1BN  
EXTERNAL REFURBISHMENT WORKS

Drawing Title:  
EXISTING & PROPOSED  
ROOF PLAN

Scale @	A3	Drawn	Date	Checked	Date	Approved	Date
1:100		RK	01/05/19	JT	01/05/19	JT	01/05/19
Project No.	Office	Type	Drawing No.		Revision		
A087905-34-13	21	BS	005		01		