

(C) This drawing is copyright. DO NOT SCALE FROM THIS DRAWING. Dimensions to be checked on site prior to work being carried out. This drawing is for the purpose of submitting a planning application only and it is to be read in conjunction with all other drawings and information in connection with the scheme. Any discrepancies to be reported to Callingham Associates Limited in writing prior to works proceeding. No unauthorised copying or reproducing of this drawing without prior written permission from Callingham Associates Limited

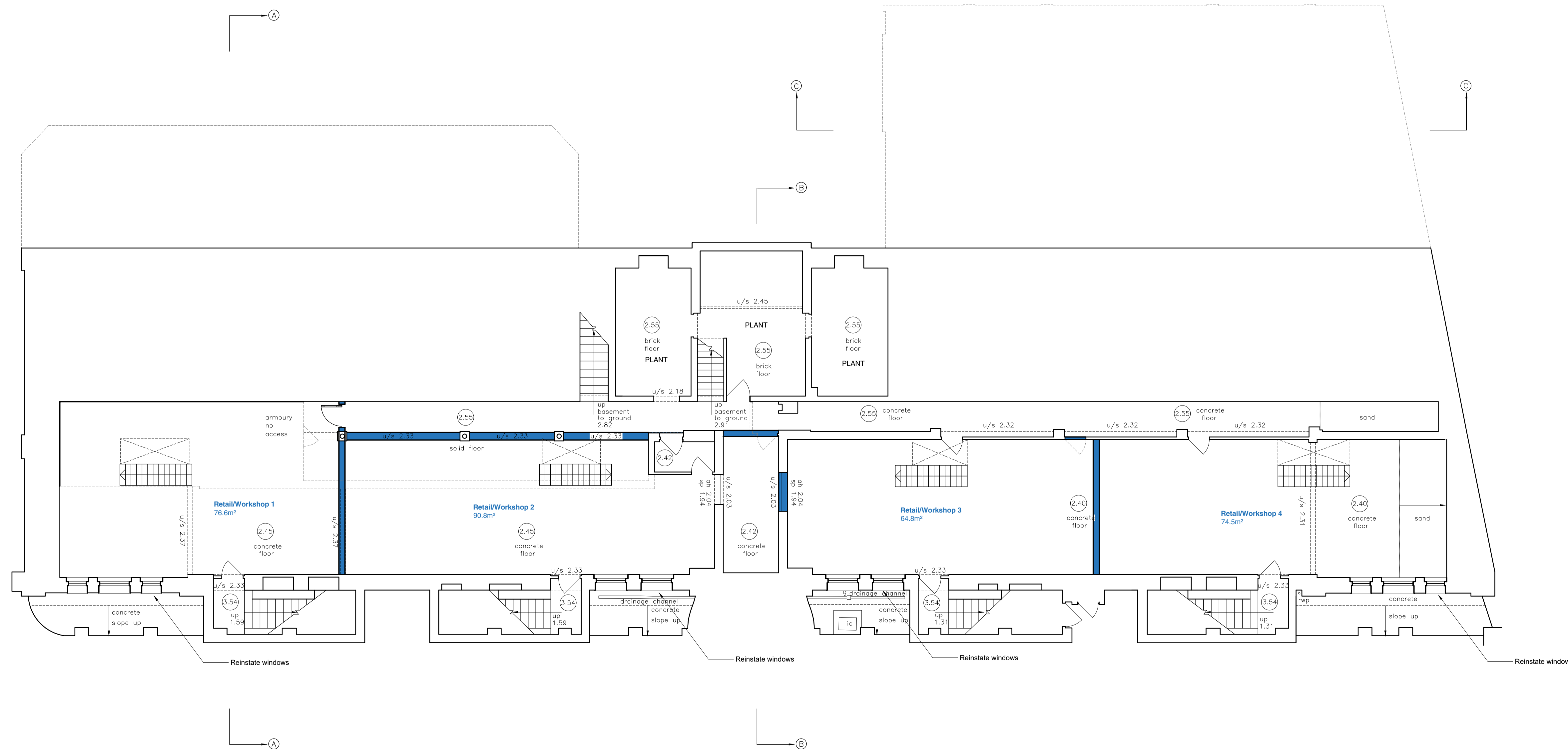
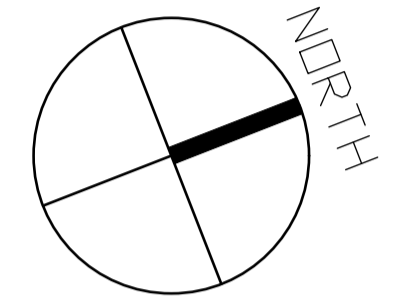

Floor	Units
Basement	4No Retail/Workshop
Ground Floor	4No Live/Work Flats (2 Bed), 4No 2 Bed Flats
First Floor	8No 2 Bed Flats
Second Floor	6No 2 Bed Flats, 2No 1 Bed Flats
TOTAL	24 units (22No 2 Bed, 2No 1 Bed + 4No retail/workshops)

Total Development	Area (m²)
Refurb	
Basement	446m²
Ground Floor	728m²
First Floor	719m²
Total	1891m²

New Build	Area (m²)
Second Floor	575m²
TOTAL	2466m²

B	25.03.19	New Wall Hatch	LT
A	05.03.19	Amendments Following Meeting	LC



2 Hearsall Lane, Coventry, CV5 6QR, tel: 024 7671 3872
 also at 1 Chapel Street, Warwick, CV34 4HL,
 t: 01926 405595 - f: 01926 405522
 e: architect@callingham-associates.co.uk
 www.callingham.co

PROPOSED DEVELOPMENT AT
 FOLESHILL ROAD
 COVENTRY
 CV1 4JZ

MR SIDHU

PROPOSED BASEMENT PLAN

scale: 1:100@A1 date: 21.01.19 drawn by: LC

drg: **1098.101B** checked by: xx

BASEMENT