

REVISIONS

A	24/09/18	PSL	SS
ON-SITE TREES PREVIOUSLY REMOVED OMITTED			
2 No BIN STORES ADDED. BIN STORE REFERENCE REVISED TO BIN HOLDING AREA			
B	12/10/18	ST	SS
Block C new build extension area reduced to increase distance to site boundary. Adjacency distances added to Block C.			
C	17/10/18	ST	SS
Lightwell shown to Block A Lower Ground Floor. Block A Courtyard planting amended.			
D	05/11/18	PSL	SS
Boundary notes added. Part retaining walls omitted along northern site boundary (subject to confirmation of site boundary)			
E	20/02/19	PSL	SS
Updated to latest site proposals			

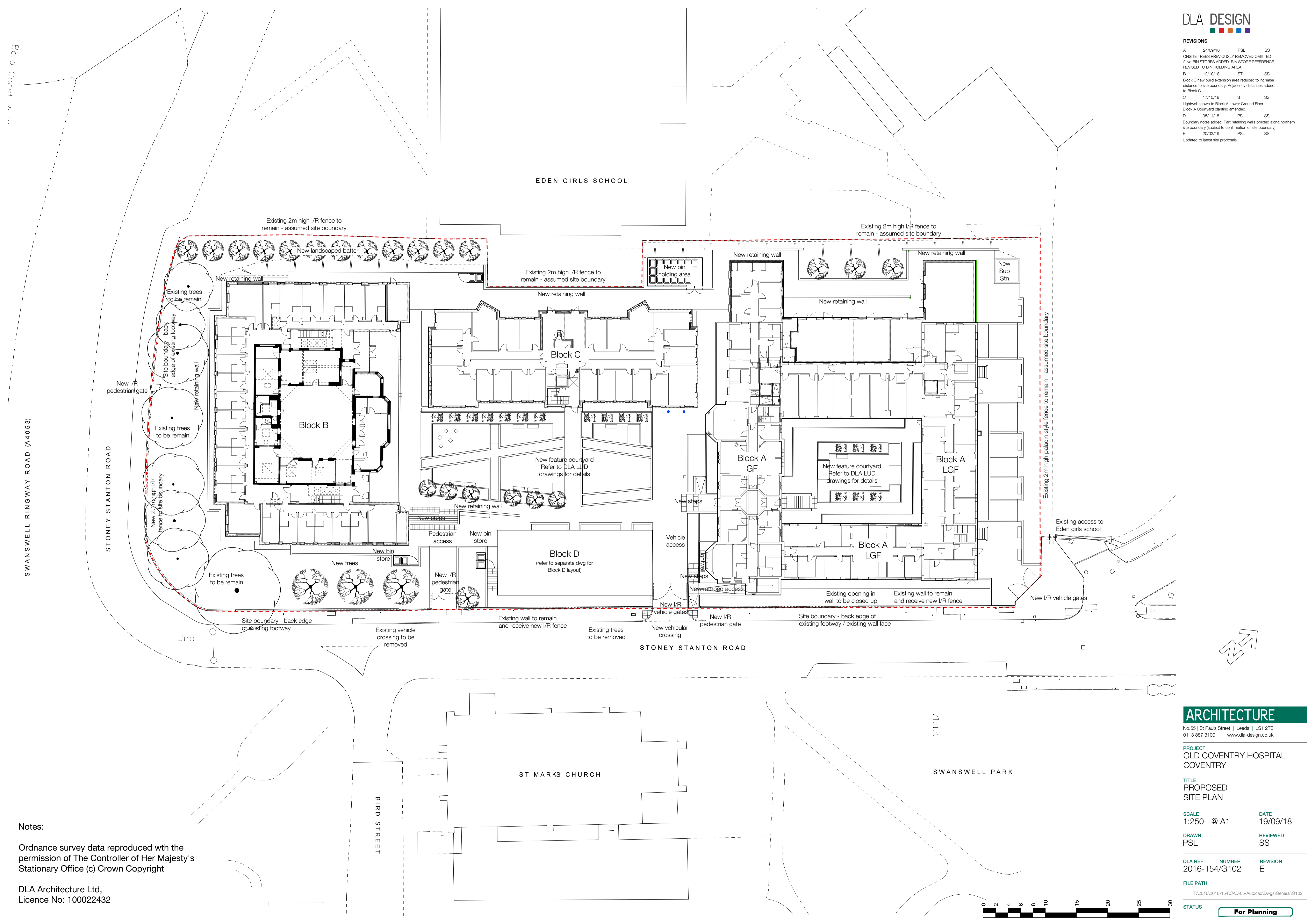

SWANSWELL RINGWAY ROAD (A4053)

STONEY STANTON ROAD

STONEY STANTON ROAD

BIRD STREET

SWANSWELL PARK

Notes:  
Ordnance survey data reproduced with the permission of The Controller of Her Majesty's Stationary Office (c) Crown Copyright

DLA Architecture Ltd,  
Licence No: 100022432

ARCHITECTURE

No.55 | St Pauls Street | Leeds | LS1 2TE  
0113 887 3100 www.dla-design.co.uk

PROJECT  
OLD COVENTRY HOSPITAL  
COVENTRY

TITLE  
PROPOSED  
SITE PLAN

SCALE 1:250 @ A1 DATE 19/09/18  
DRAWN PSL REVIEWED SS

DLA REF NUMBER REVISION  
2016-154/G102 E

FILE PATH  
T:\2016\2016-154\CAD\05-Autocad\Drawings\General\G102

STATUS For Planning