

**ANY CONSTRUCTION WITHIN RETAINED ROOT PROTECTION AREAS IS TO BE CARRIED OUT WITH NO DIG CONSTRUCTION TO ARBORICULTURISTS RECOMMENDATIONS.**

**Notes**

- This drawing is based on following documents:
- Stephen George and Partners Architects Illustrative Masterplan (drg.no 17-064-SK02 rev E) and Residential Development Framework (drg.no 17-064-SK100 rev B).
  - BWB Engineers Proposed Access Arrangements (drg no. RFC-BWB-GEN-00-DR-TR-101-S2revP1).
  - BCA Landscape Architect's Tree Constraints Plan (drg.no.1856/18-01)
- Refer to Ben Bennett Tree and Woodland Consultancy Pre-Development Tree Survey dated Thursday 10th May 2018 for details of existing trees.
- Tree locations shown are based on information provided by Greenhatch Surveys
- This drawing has been prepared in accordance with BS5837:2012.

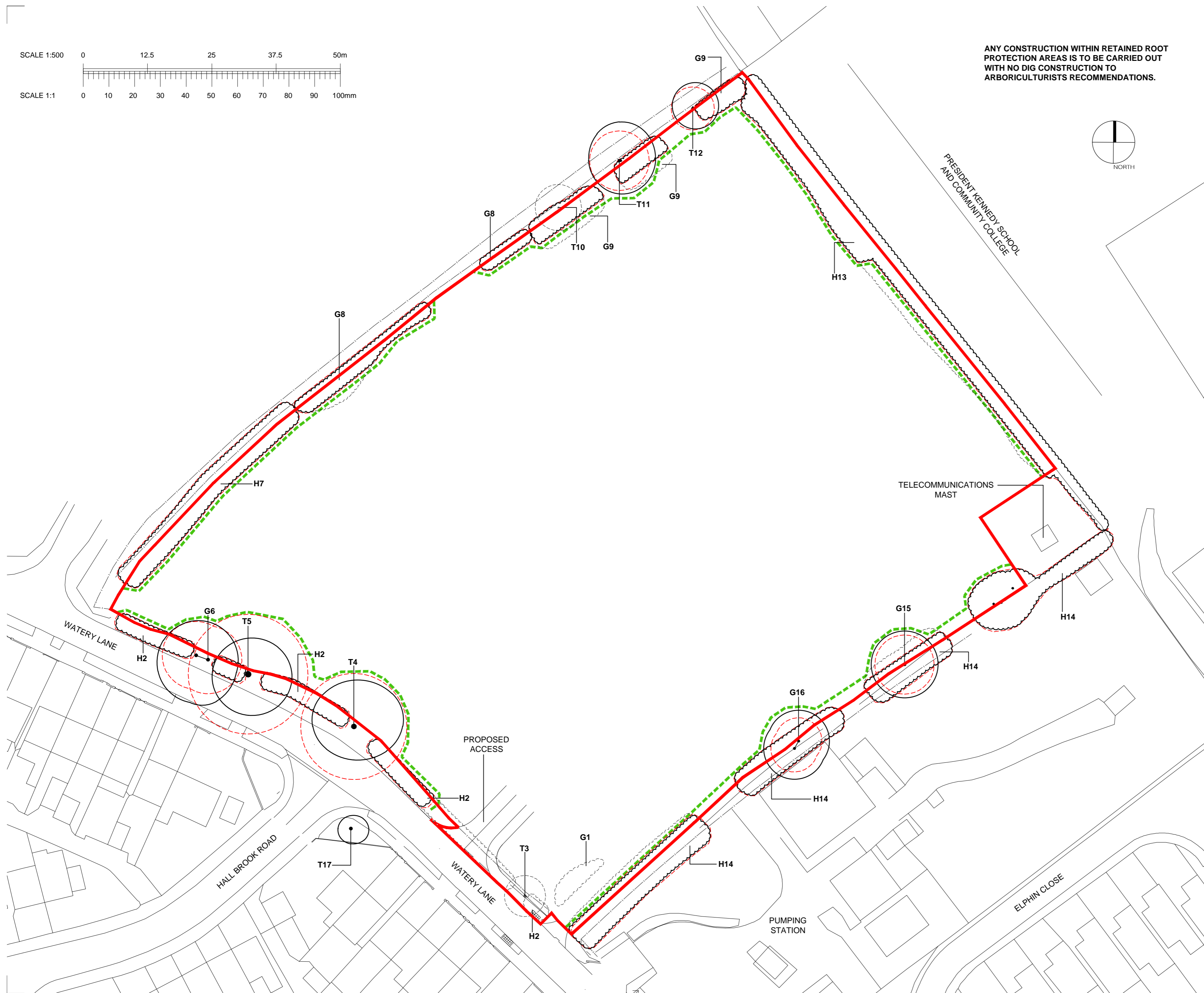
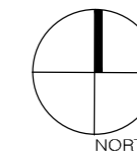

- ROOT PROTECTION ZONE: Red dashed line around protected trees indicates the minimum Root Protection Area required in accordance with Pre-development tree survey dated Thursday 10th May 2018.
- PROTECTIVE BARRIER: Existing trees to be retained shall be protected by protective barrier erected in accordance with the specification figure 2 of BS5837:2012. Barrier to be erected on the edge of the root protection area for each tree to be protected. To be erected prior to the commencement of any construction works on site.
- EXISTING TREES TO BE TO BE RETAINED AND PROTECTED AS PART OF THE PROPOSALS
- EXISTING TREES TO BE REMOVED AS PART OF THE DEVELOPMENT
- SITE BOUNDARY

REV NOTE DATE AUTH



CLIENT  
J G GRAY LTD  
GILLITT PROPERTIES LTD  
THE NEWCOMBE ESTATES COMPANY LTD

PROJECT  
**ROOKERY FARM,  
WATERY LANE, COVENTRY,**

DRAWING  
**TREE RETENTION, REMOVAL  
AND PROTECTION PLAN**

CONTRACT	1856/18	DRG NO.	02
DATE	28/09/18	DRAWN	
ISSUE	PLANNING	CHECKED	DR
SCALE	1:500	ORG SHEET	A2
CAD FILE	1856-18_02_Tree Retention Removal Plan.dwg		
REV	-		