

Disclaimer
 © This drawing is the copyright of BBLB Architects and may not be reproduced or used except by written permission.
 This drawing may include information provided by third parties including civil and structural, M&E and other specialist consultants and sub-contractors. BBLB relies on the specialist's knowledge and expertise of these third parties and does not warrant the accuracy of this information and this is to be read as illustrative only.
 If you notice any discrepancies between drawings/information supplied by BBLB and drawings/information supplied by other contractors, specialist consultants or sub-contractors, you should immediately inform BBLB. Please notify BBLB immediately detailing the discrepancies which have been identified.
 Unless otherwise expressly agreed, BBLB's design responsibility is limited to the design of the permanent works as finally constructed only in accordance with BBLB's design.
 Do not scale use given dimensions only.
 Read this drawing in conjunction with the specification.
 Check site dimensions prior to construction.
 Wherever specifically stated or not, all work is to comply with:
 The Building Regulations,
 The requirements of the NHBC Zurich,
 The clients general development brief.

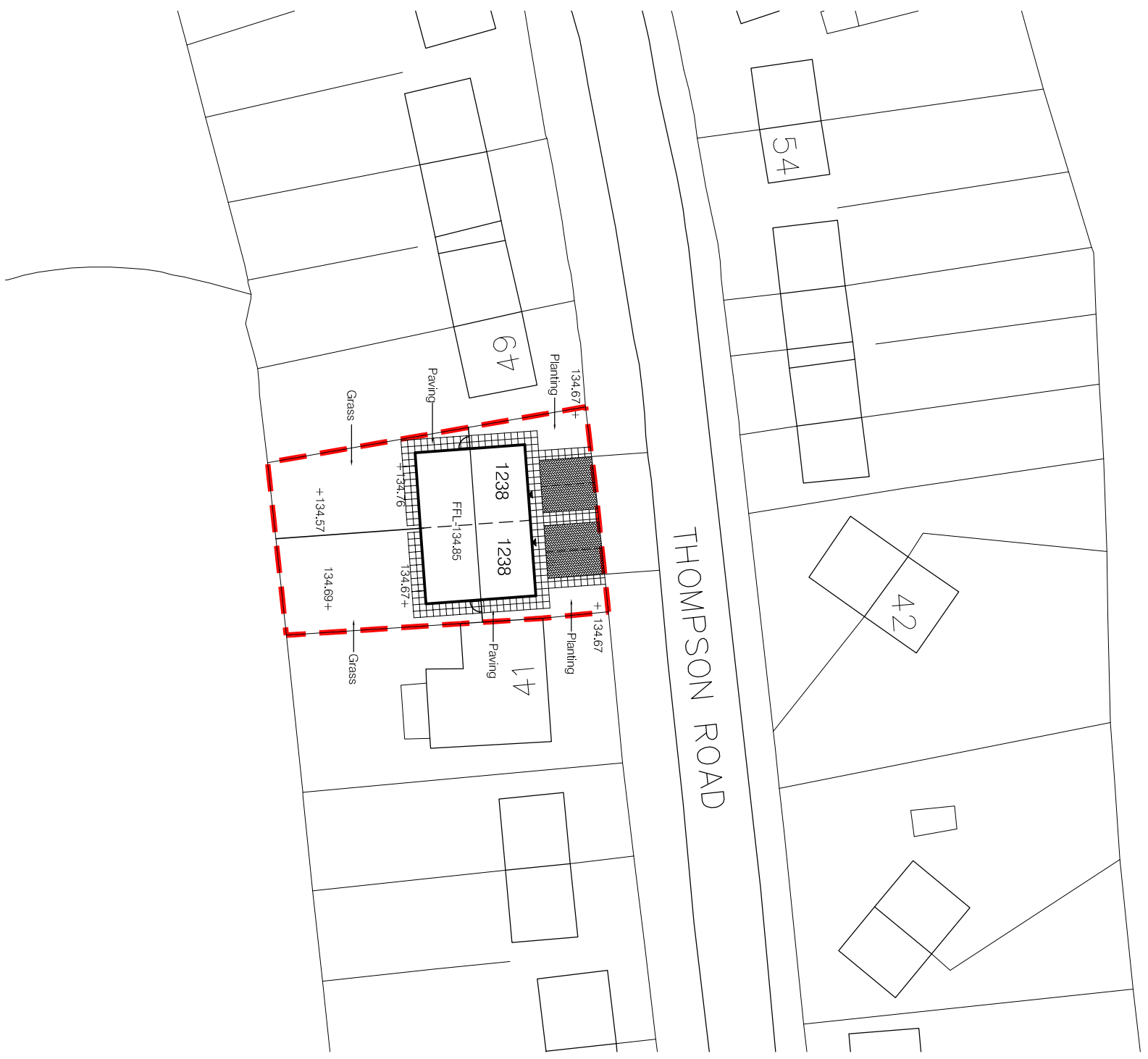

schedule of accommodation			
	area	n°	total area (ft²)
1238 - 4 bed, 6 person, 2 storey	1238	2	2476
total		2	2476
site area (ha)			0.05
site area (acre)			0.13
parking provision			4 spaces (200%)

Drainage Note:
 Foul
 Foul drainage to connect to existing drain in Thompsons Road.
 Surface
 Percolation test to be performed to see if a soakaway is possible. If not surface water to be drained into SW drain in Thompsons Road.

A: 14.05.13 Levels, drainage notes and landscape info added RJH

REV DATE AMENDMENT BY CHK
Planning



CLIENT
 Thompson's Road
 Keresley

JOB TITLE
 Proposed Site Plan

BBLB architects llp
 The Old Library,
 Hogley Road, Stourbridge,
 West Midlands, DY8 1QH.
 t: + 44 (0) 1394 880 550
 f: + 44 (0) 1394 880 551
 e: info@bblb-architects.co.uk
 www: bblb-architects.co.uk

SCALE 1:500@A3 **DATE** Oct 2012

DRAWN LL **CHECKED** JB

JOB NO 12079

DWG NO P02 **REV** A