

Disclaimer
 © This drawing is the copyright of BBLB Architects and may not be reproduced or used except by written permission.

This drawing may include information provided by third parties including civil and structural, M&E and other specialist consultants and sub-contractors. BBLB relies on the specialist knowledge and expertise of these third parties and does not warrant the accuracy of this information and this is to be relied on illustrative only.

If you notice any discrepancies between drawings/information supplied by BBLB and drawings/information supplied by other contractors, specialist consultants or sub-contractors, please notify BBLB immediately so that these discrepancies which have been identified.

Unless otherwise expressly agreed, BBLB's design responsibility is limited to the design of the permanent works as finally constructed only in accordance with BBLB's design.

Do not scale. Use given dimensions only.
 Read this drawing in conjunction with the specification.

Check site dimensions prior to construction.
 Wherever specifically stated or not, all work is to comply with:

The Building Regulations.
 The requirements of the NHBC Zurich.
 The clients general development brief.

REV	DATE	AMENDMENT	BY	CHK

PLANNING

CLIENT



JOB TITLE

Thompson's Road
 Keresley

DRAWING

Street Scene

BBLB architects llp

The Old Library,
 Hogley Road, Stourbridge,
 West Midlands, DY8 1QH.
 t: + 44 (0) 1394 880 550
 f: + 44 (0) 1394 880 551
 e: info@bblb-architects.co.uk
 www: bblb-architects.co.uk

SCALE	DATE
1:200@A3 1:1000@A3	APR 2012

DRAWN	CHECKED
RJH	JB

JOB NO
12079

DWG NO	REV
P04	



Street Scene

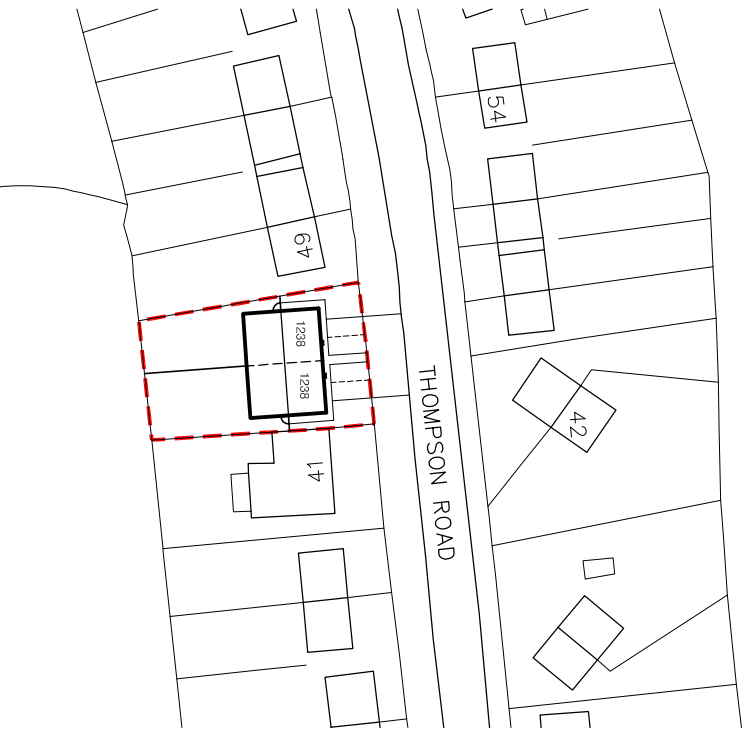

Site Plan